

# ALDUS Composite Bi-Fold Doors





## ALDUS Composite Bi-Fold Doors

Rationel's range of ALDUS Bi-Folding doors offers you peace of mind. A system that has been installed internationally for over 25 years, providing you a guarantee of quality and longevity. The natural beauty of internal timber with the strength of thermally broken aluminium on the external face offers virtually maintenance free doors with the slimmest sight line (114mm) available for a composite folding door. The most weather tight folding door available (900 Pascals of water pressure) with standard weathered track along with a choice of double or triple glazing makes the Rationel ALDUS Bi-Folding doors the obvious choice for your project.



### Product Information

- Double glazed or triple glazed depending upon your project requirements.
- Slim line, square edge, contemporary external aluminium profile.
- Pine cladding internally with a choice of timber stains and colours to match the look and feel of your room.
- Choice of over 200 external aluminium colours with 5 standard stocked colours.
- Flush track available for the double glazed system to offer a seamless threshold bringing the outside inside.
- Revolutionary narrow sight lines (114mm) maximising light and enhancing your view, the slimmest available for a composite folding door.
- Triple gasket for finger cushioning and tight compression seals.
- Severe weather rated with our standard weathered track and double rebates on all sides. The most weather tight folding door available (900 Pascals water pressure).
- Mushroom locking into side jambs coupled with metal shootbolt rods top and bottom, locking hinge pins and double rebated frames ensuring excellent security.
- Sound insulation Rw36dB (with Rw36dB glass) according to DIN EN ISO 140-3.
- Subtle hinges, hidden running gear and handles in line with the door frame provide an uninterrupted view through the doors.
- Widths of up to 20 metres and heights of 3.5 metres providing a solution for the most challenging of projects.



\*PIV Test Reports No. 23-21/09E, no. 40-29/09 and no. 40-30/09  
\*PIV Test Reports No. 23-21/09E, no. 40-12/12 and no. 40-13/12



\*\* Test Report 1286-001-10



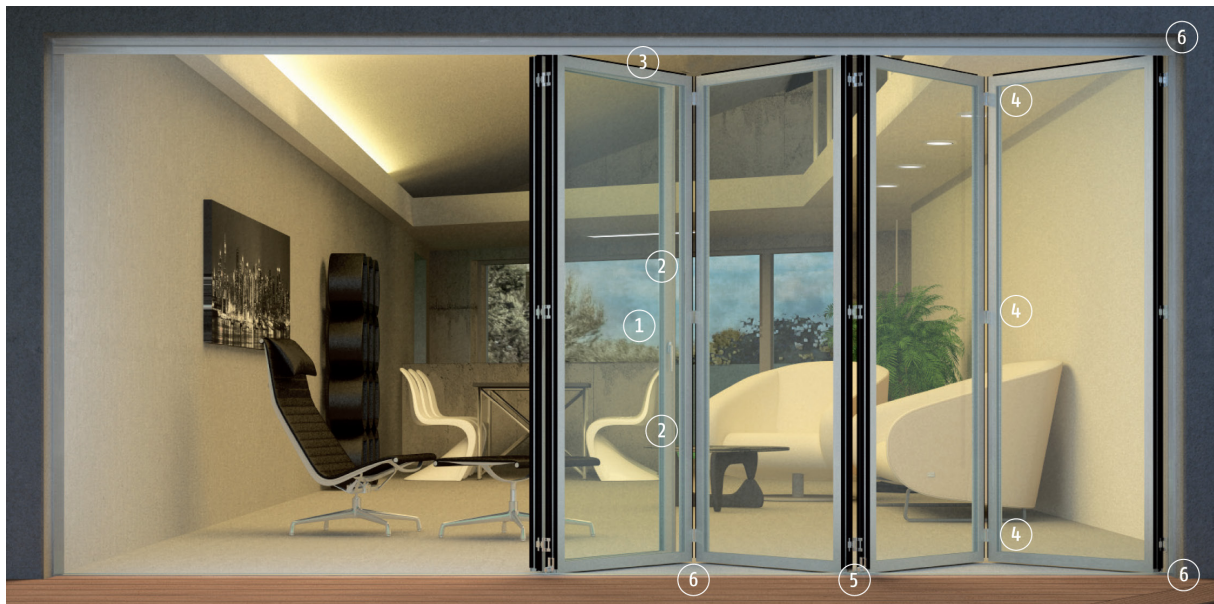

*Flush and Lever handles available*

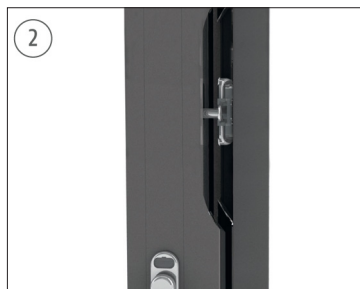

*Mushroom headed lock coupled with top and bottom metal shootbolt rods for increased security*



*Panel catch to hold single door back and ensures a neat stable stack when open*



*Hinge pins secured by grub screws to prevent each panel being separated*



*Height adjustment of the running mechanism is possible in case of construction movement*



*Side jambs slide into the top and bottom tracks aiding precise and weather tight installation*

## Corner Opening Applications

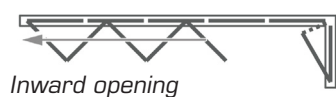

*Inward opening*

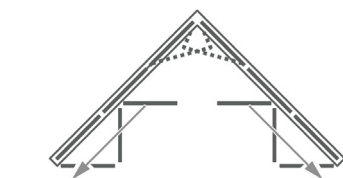

*Inward Opening*



*Outward opening*

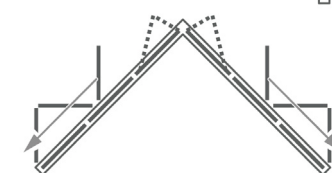

*Outward Opening*

## ALDUS double glazed System threshold options

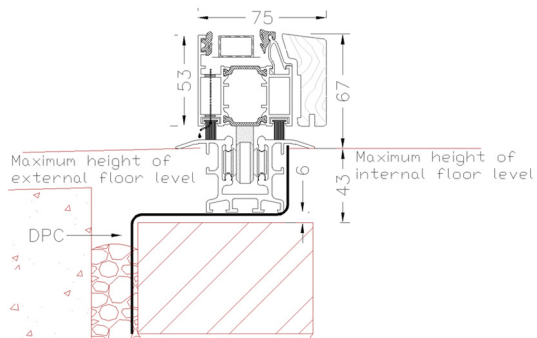

### **Open in or out flush track**

*Designed to be used in a sheltered location giving a seamless walk through between inside and out. External floor finish should slope away towards a drainage channel.*

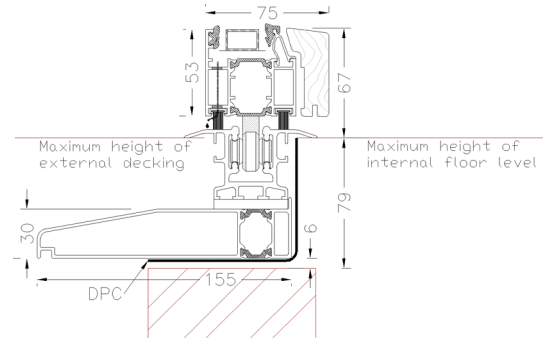

### **Open in or out flush track on aluminium sill**

*Designed to be used in a sheltered location giving a seamless walk through internal flooring and external decking. The aluminium sill below the deck provides a run off for rainwater.*

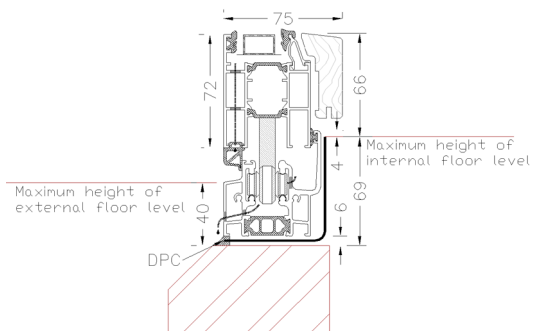

### **Open out weathered track**

*Designed to be used in exposed locations or where there is a step down to the outside. External floor finish can be set just 29mm lower than inside for a minimal transition between in and out.*

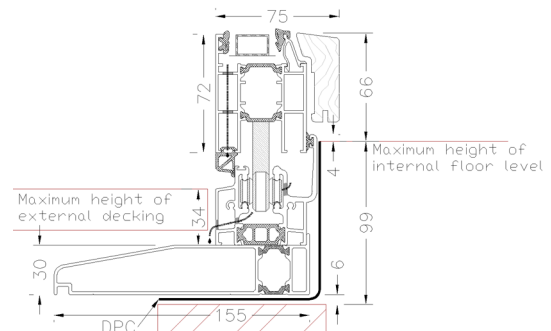

### **Open out weathered track on aluminium sill**

*Designed to be used in exposed locations or where there is a step down to the outside. External decking can be set just 29mm lower than inside with the sill providing a run off for rainwater.*

## ALDUS triple glazed System threshold options

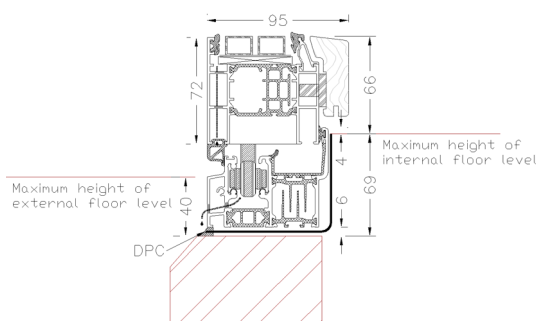

### **Open out weathered track**

*Designed to accommodate a step down to the outside. External floor finish can be set just 29mm lower than inside for a minimal transition between inside and outside offering unrivalled weather resistance.*

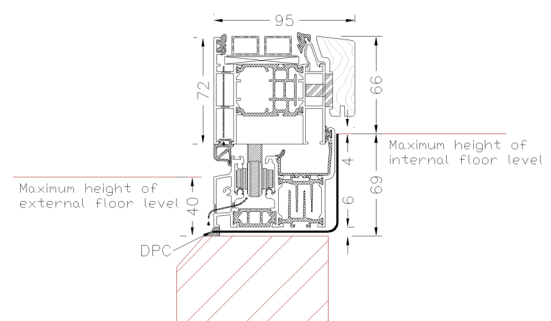

### **Open out weathered track on aluminium sill**

*Designed to be used where there is a step down to the outside. External decking can be set just 29mm lower than inside with the sill providing a run off for rainwater with full weather protection.*

## Handling

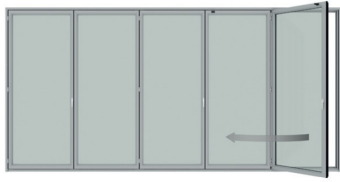

*Any odd number opening configuration offers a single access door that latches on to the next panel*

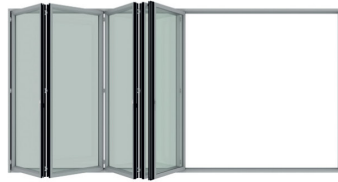

*The panels then begin to fold to one side*



*All panels neatly stack 90 degrees to the track at one side*

## ALDUS double glazed Bi-folding door

System Performance to EN 14351 – 1:2006

Resistance to Wind load: Class 4 (1600 Pa.)  
 Resistance to Wind Load: Class B (<1/200)  
 Air Permeability: Class 4 (600 Pa.)  
 Water Tightness: Class E (900 Pa.)

Thermal Performance – Double Glazed

Centre Pane U-Value 1.2 W/m <sup>2</sup> K	Overall U-Value 1.6 W/m <sup>2</sup> K
Centre Pane U-Value 1.1 W/m <sup>2</sup> K	Overall U-Value 1.5 W/m <sup>2</sup> K
Centre Pane U-Value 1.0 W/m <sup>2</sup> K	Overall U-Value 1.5 W/m <sup>2</sup> K



## ALDUS triple glazed Bi-folding door

System Performance to EN 14351 – 1:2006

Resistance to Wind load: Class 4 (1600 Pa.)  
 Resistance to Wind Load: Class B (<1/200)  
 Air Permeability: Class 4 (600 Pa.)  
 Water Tightness: Class E (900 Pa.)

Thermal Performance – Triple Glazed

Centre Pane U-Value 0.7 W/m <sup>2</sup> K	Overall U-Value 1.0 W/m <sup>2</sup> K
Centre Pane U-Value 0.6 W/m <sup>2</sup> K	Overall U-Value 0.9 W/m <sup>2</sup> K
Centre Pane U-Value 1.0 W/m <sup>2</sup> K	Overall U-Value 1.5 W/m <sup>2</sup> K





*Composite Bi-Folding Doors*



*Flush Track*

Good, solid quality workmanship has characterised Rationel's windows and doors since the first products were shipped from our factory in Sdr. Felding in 1954. On that basis, Rationel has created a sound foundation, and is today an international company with sales activities in Denmark, Great Britain and Ireland.

Rationel manufactures energy saving windows and doors of premium quality in terms of comfort and security. We develop our windows and doors continuously, ensuring that they will always meet current statutory requirements as well as market requirements for design and functionality. For further information about our wide range of windows and doors, for classic and modern buildings, please visit [www.rationel.co.uk](http://www.rationel.co.uk).

Rationel is part of the DOVISTA Group which consists of ten leading door and window companies in Europe. DOVISTA A/S is owned by VKR Holding and employs approx. 15,000 people in more than 40 countries.

